

# Double Pitch Conveyor Chain

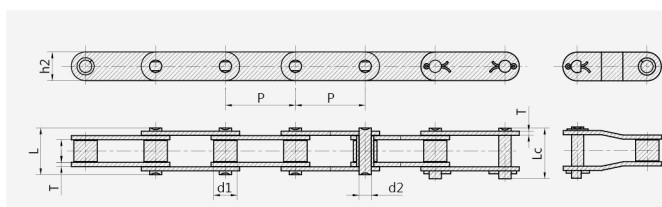

## Small Roller Type



## Large Roller Type

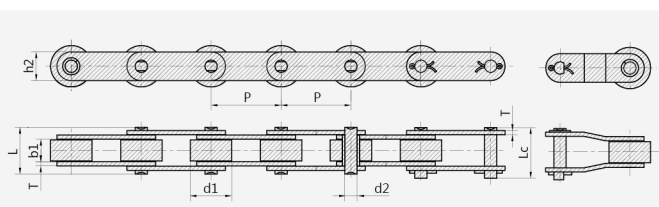

Chain No.	Pitch P [mm]	Roller diameter d1 max [mm]	Width between inner plates b1 min [mm]	Pin diameter d2 max [mm]	Pin length L max [mm]	Pin length Lc max [mm]	Innerplate depth h2 max [mm]	Plate thickness T max [mm]	Breaking load Q [kN/lbf]	Weight per meter q [kg/m]
C2040SS	25.40	7.95	7.85	3.96	16.6	17.8	12.0	1.50	9.6/2182	0.51
C2042SS	25.40	15.88	7.85	3.96	16.6	17.8	12.0	1.50	9.6/2182	0.85
C2040HSS	25.40	7.95	7.85	3.96	18.8	19.9	12.0	2.03	9.6/2182	0.66
C208BSS	25.40	8.51	7.75	4.45	16.7	18.2	11.8	1.60	12.0/2727	0.56
C208BLSS	25.40	15.88	7.75	4.45	16.7	18.2	11.8	1.60	12.0/2727	0.90
C2050SS	31.75	10.16	9.40	5.08	20.7	22.2	15.0	2.03	15.2/3455	0.79
C2052SS	31.75	19.05	9.40	5.08	20.7	22.2	15.0	2.03	15.2/3455	1.29
C2060SS	38.10	11.91	12.57	5.94	25.9	27.7	18.0	2.42	21.7/4932	1.13
C2062SS	38.10	22.23	12.57	5.94	25.9	27.7	18.0	2.42	21.7/4932	1.63
C2060HSS	38.10	11.91	12.57	5.94	29.2	31.6	18.0	3.25	21.7/4932	1.46
C2062HSS	38.10	22.23	12.57	5.94	29.2	31.6	18.0	3.25	21.7/4932	2.10
C2080SS	50.80	15.88	15.75	7.92	32.7	36.5	24.0	3.25	38.9/8841	2.11
C2082SS	50.80	28.58	15.75	7.92	32.7	36.5	24.0	3.25	38.9/8841	3.16
C2080HSS	50.80	15.88	15.75	7.92	36.2	39.4	24.0	4.00	38.9/8841	2.57
C2082HSS	50.80	28.58	15.75	7.92	36.2	39.4	24.0	4.00	38.9/8841	3.63
C2100SS	63.50	19.05	18.90	9.53	40.4	44.7	30.0	4.00	60.0/13636	3.05
C2102SS	63.50	39.67	18.90	9.53	40.4	44.7	30.0	4.00	60.0/13636	4.89
C2100HSS	63.50	19.05	18.90	9.53	43.6	46.9	30.0	4.80	60.0/13636	3.61
C2102HSS	63.50	39.67	18.90	9.53	43.6	46.9	30.0	4.80	60.0/13636	5.45